

Ametis M-Series Valve Horizontal Trim with Four Handles

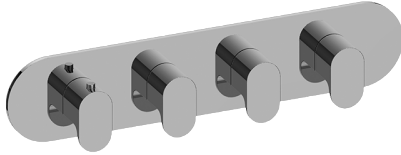

- Four metal handles
- Decorative trim plate
- Multiple valve options and configurations
- To complete package, you must order rough valves

- ADA

- Architectural Black™
- Architectural Black™
- Matte Black
- Matte Black
- Polished Chrome
- Architectural White
- Architectural White

Technical drawing of a metal plate with the following dimensions and features:

- Overall Length:** 18-9/16" (472mm)
- Overall Width:** 3-15/16" (100mm)
- Top Hole:** A small rectangular hole with a width of 3-3/8" (86mm).
- Bottom Hole:** A larger oval hole with a width of 3-15/16" (100mm) and a height of 13/16" (20mm).
- Spacing:** The distance between the center of the top hole and the center of the bottom hole is 3-15/16" (100mm).
- End Hole:** A hole at the right end with a radius of R 1-15/16" (50mm).

